

Revolutionary change
in the way we store,
transport and protect
our archery equipment



ALARIS CONCEPTS

Phone: 780-842-7150
Website: www.bowkaddy.com
Email: arliss@alarisconcepts.com

Polaris* RZR* Bowkaddy Installation Instructions

This installation is unique in that the roll bars to which Kaddy Bracket UTV is attached are horizontal. As well, the top bar is larger in diameter than the lower bar. Because the UTV Bracket comes with U-bolts designed to work on 1-1/2" tubes, a larger U-bolt is recommended for the top roll bar (1-3/4" diameter). 5/16" x 1-3/4" U-bolts can be purchased at your local bolt supply store. If the one you find is too long, the threaded ends can be cut off as shown below. The U-bolt will then need to be slightly widened to fit in the prescribed holes. Though not required, it is recommended that the unthreaded portion be rubber or plastic-coated to minimize abrasion and provide vibration dampening. These bolts are also available upon request from Alaris Concepts to those who have purchased a UTV Bracket for their RZR.

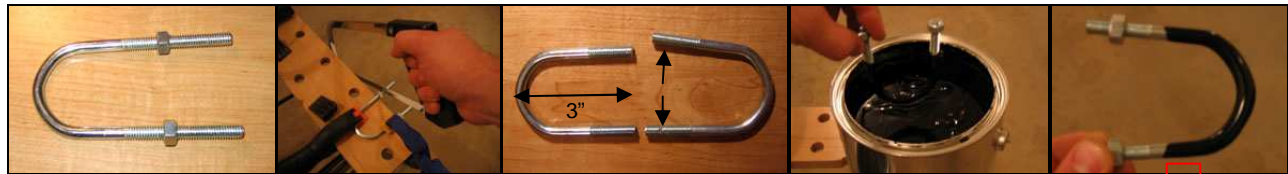

With the issue of the U-bolt resolved, the last modification is to drill two additional 21/64" holes along the mid-line, as shown.

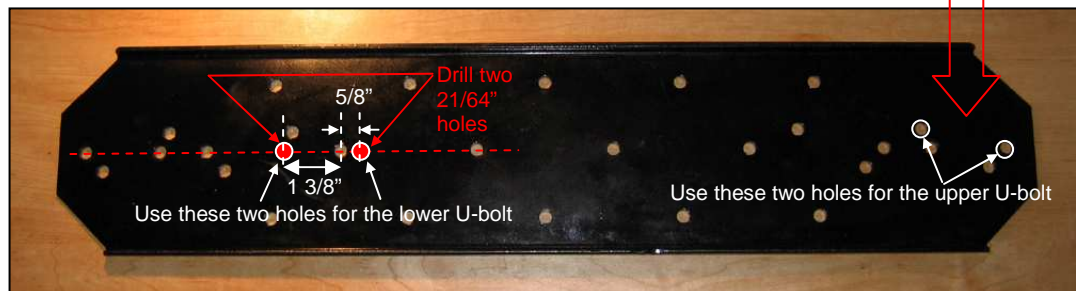

You're now ready to install the UTV Bracket on your Polaris RZR as per the instructions included with Kaddy Bracket UTV. Note that one or two bows can easily be mounted to one or two UTV Brackets depending on the owner's preference.



For more product and installation information, visit www.bowkaddy.com or contact Alaris Concepts.

*Polaris and RZR are registered trademarks of Polaris Industries Inc.

Rev 7/31/08. Copyright 2008 Alaris Concepts. All Rights Reserved.